

Setting up the Abbott FreeGo[®] Pump System



A step-by-step guide

FreeGo® Setting up the Abbott FreeGo® pump system

Freedom for life



1

PREPARE THE PUMP AND STAND

- A. Assemble the Abbott FreeGo® table drip stand. Attach the pole clamp to the back of the Abbott FreeGo® pump by turning the grey wheel clockwise.
- B. Screw the pole clamp onto the stand, ensuring the small black end aligns with the green dot on the stand.
- C. Connect the power supply and switch on the pump.

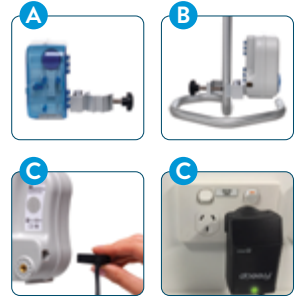

2

ATTACH AND HANG FEED

- A. Attach the feedcap end of the Abbott FreeGo® giving set securely to the Ready-to-Hang (RTH) tube feed container.
- B. Hang the tube feed container upside down from the hook on the stand.

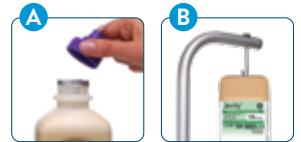

3

LOAD THE GIVING SET

- A. Open pump door.
- B. Grasp the lilac cassette body on the giving set and loop the pump insert around the rotor, stretching lightly.
- C. Pull down gently to seat the lilac cassette into the pump.
- D. Firmly press tubing into slots below the cassette and close the pump door securely.

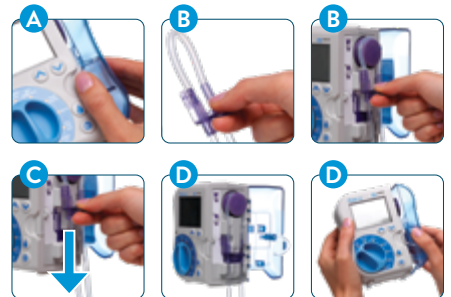

4

PRIME THE GIVING SET

- A. Turn the pump dial to 'SET RATE' or 'SET DOSE'.
- B. Press and hold the 'PRIME' button for 2 seconds, then release. The display will indicate 'PRIMING'. Auto-priming will continue until the priming volume is reached. To stop the process before it has finished, press and release the 'PRIME' button.



5

PROGRAMME THE PUMP

- A. SET RATE
Turn pump dial to 'SET RATE'. Then, select the prescribed flow rate by pressing the up and down arrow buttons while observing the entry on the display. Keeping an arrow button depressed will increase the scroll rate.
- B. SET DOSE
Turn the dial to 'SET DOSE' and programme the prescribed dose using the up and down arrow buttons. Keeping an arrow button depressed will increase the scroll rate.

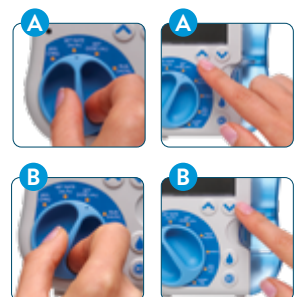

6

AT THE START OF EACH FEEDING SESSION

Additional steps need to be taken before the start of each feeding session or after interrupting the feed by turning the pump off and on or opening the pump door (you do not need to take this additional step if you interrupt the feed by using the 'HOLD' function on the pump).

Prime the giving set according to the instructions provided in **step 4**. Then follow the steps below to ensure the product is moving through to the end of the set. Do not connect the feeding tube to the giving set during this priming step.

- A.** Position a cup under the ENFit connector. With the pump dial in the 'SET RATE' or 'SET DOSE' position, press and hold the prime button for an additional 5 seconds until you see feed flowing into a cup. If the feed is not flowing into the cup, consult the Abbott FreeGo® Pump Operator Manual for troubleshooting and repeat this step.
- B.** After confirming that feed is flowing into the cup, connect the giving set to the feeding tube.
- C.** Check that the feeding tube is open, any clamp on the feeding tube is open, and if the giving set has a flush port ensure it is in the correct position for feeding.



Scan here to view a video detailing the additional steps.

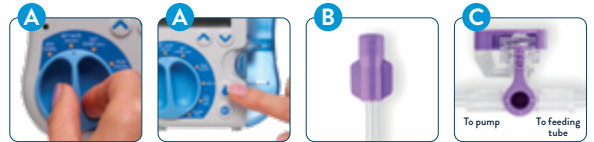

7

START THE PUMP

- A.** Turn the dial on the pump to 'RUN' to start feeding. Do not turn the pump off and do not open the pump door before starting the feeding session.



Important note: Once you have started a feeding session by turning the pump to 'RUN', DO NOT turn the pump off or open the pump door. If you need to interrupt the feeding session, switch the dial to 'HOLD'. During a feeding session, if there is any interruption to the feed by turning the pump off and on or opening the pump door, then disconnect the giving set from the feeding tube and complete steps **6A** through **C**.

8

ONCE FEEDING IS COMPLETE

- A.** Turn the pump to 'HOLD' to prevent further alarms.
- B.** Disconnect the giving set from the feeding tube.
- C.** Adjust the pump dial to 'CLEAR VOL'; then turn it to 'OFF'.
- D.** Finally, flush the feeding tube as prescribed.

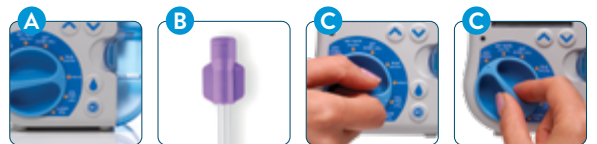











NOTE: If alarm sounds, turn pump dial to 'HOLD'. Take appropriate action for the alarm that has been indicated on the LCD display, then turn dial to 'RUN' to restart feeding. Please see the back page of this leaflet for a guide on pump alarms and alerts.

For further information on setting up and using the Abbott FreeGo® pump, please refer to the operator manual. If you have any other questions about the Abbott FreeGo® pump and feeding system, please phone the Abbott Homecare Connect Nursing Service on 1800 971 557. In New Zealand, please phone Abbott Nutrition on 0800 737 115.



If any changes to feeding function occur with the pump, the alarm will sound and the display will flash. To silence the alarm, turn the dial to 'HOLD' and take the appropriate action as shown below.

Screen display	Possible cause	Action to take
 ATTN PUMP ON HOLD	This means that the pump hold time has elapsed	<ul style="list-style-type: none"> Turn dial to RUN to restart the pump
 BATT BATT EMPTY	This means the pump battery is depleted and the pump has stopped working	<ul style="list-style-type: none"> Plug the power cord into a mains outlet and make sure the power is turned on The green light on the charger will illuminate to indicate that the pump is being recharged The display will indicate CHRG PLEASE WAIT until pump is ready to use
 BATT LOW BATTERY	This means the pump battery is nearly empty and approximately 20 minutes of battery operation remain	<ul style="list-style-type: none"> Plug the power cord into a mains outlet and make sure the power is turned on The green light on the charger will illuminate to indicate that the pump is being recharged
 CHRG PLEASE WAIT	The battery charge is below the minimum level to operate and the pump cannot be used until minimum charge level is reached	<ul style="list-style-type: none"> No action can be taken Pump is available for use when the display indicates PUMP READY TO USE
 PUMP READY TO USE	The battery charge has reached the minimum level to operate and the pump can now be used	<ul style="list-style-type: none"> Turn pump dial to any position to clear message Confirm all pump settings are accurate Turn pump dial to RUN to continue feeding
 NO CASSETTE	This means that either there is no cassette installed or that the cassette was installed incorrectly when attempting to run pump or prime giving set	<ul style="list-style-type: none"> Turn pump dial to HOLD Insert the cassette on the giving set correctly into the slot in the pump and close pump door Turn pump dial to RUN to begin feeding, or attempt to prime the giving set again
 ER## SYSTEM FAIL	This indicates a pump malfunction	<ul style="list-style-type: none"> Remove the pump immediately Turn the pump dial to OFF/CHRG and contact the Abbott Nutrition Service Centre on 1800 819 831
 DOSE DONE	This shows the pump has completed delivering the programmed dose NOTE: If your healthcare professional advises you not to set a dose, depress the down arrow until INF DOSE is displayed (the pump will feed until the container is empty)	<p>If you have finished feeding:</p> <ul style="list-style-type: none"> Turn pump dial to OFF/CHRG as the required dose has been delivered. This message is displayed because VOL FED has reached your SET DOSE <p>Or... If you have more feed to deliver:</p> <ul style="list-style-type: none"> Turn pump dial to CLEAR VOL (after 5 seconds, volume will be cleared) Turn pump dial to SET DOSE and use the up and down arrow buttons to set your remaining dose to be delivered Turn pump dial to RUN to restart the pump and begin feeding
 FEED EMPTY	This means that air has been detected in the giving set	<p>If you are beginning a feeding:</p> <ul style="list-style-type: none"> Open the pump door. Gently press the tubing to ensure it is fully seated in slots below the cassette Close door firmly (you will hear a click when the door has been closed properly) <p>Or... If there is more feed to deliver:</p> <ul style="list-style-type: none"> Turn pump dial to HOLD to stop the alarm Remove giving set from the feeding tube Prime air out of the giving set and securely re-attach the giving set to the feeding tube Turn pump dial to RUN to begin feeding
 OCCL INTO PUMP or OCCL OUT OF PUMP	Flow has stopped due to occlusion between the feed container and the pump or Flow has stopped due to occlusion between the pump and the patient	<ul style="list-style-type: none"> Turn pump dial to HOLD Open pump door, completely remove giving set from pump, close pump door and turn pump dial to OFF/CHRG Clear blockage or obstruction, check for kinked tubing or empty container Turn pump dial to SET RATE without the giving set inserted into the pump to recalibrate the pump sensors
 OCCL or ER 02	Flow has stopped due to occlusion or Flow has stopped due to occlusion	<ul style="list-style-type: none"> Reinstall giving set. If the pump alarms during priming, attempt to prime the giving set again, then reconnect giving set to feeding tube Turn pump dial to RUN to begin feeding

If you still have a problem using your Abbott FreeGo® pump and feeding system please phone the Abbott Homecare Connect Nursing Service on 1800 971 557. In New Zealand, please phone Abbott Nutrition on 0800 737 115.

®Registered trademark of the Abbott Group of Companies. Abbott Australasia Pty Ltd, 299 Lane Cove Road, Macquarie Park NSW 2113. ABN 95 000 180 389. Customer Service 1800 225 311. www.abbottnutrition.com.au. Abbott Laboratories NZ Ltd, Ground Floor, Bldg. D, 4 Pacific Rise, Mount Wellington, Auckland 1640. Customer Service Toll Free: 0800 737 115. www.abbottnutrition.co.nz. ANZ.2024.52551.PUM.1. August 2024.